



Honiton Gardens, Mill Hill East, NW7

OIEO £550,000

 2 Bedrooms  1 Bathroom  1 Reception





Adam Hayes - Finchley Central Office - Sales 348 Regents Park Road, Finchley Central, London, N3 2LJ  
Tel: 0208 189 6333 Email: [info@adam-hayes.co.uk](mailto:info@adam-hayes.co.uk) Web: [www.adam-hayes.co.uk](http://www.adam-hayes.co.uk)

Honiton Gardens, Mill Hill East, NW7

OIEO £550,000

2 Bedrooms 1 Bathrooms 1 Receptions

Key Features

- Two Bedrooms
- Modern Kitchen
- Off Street Parking
- Chain Free
- Guest WC
- 15ft Reception

Other Information

Tenure: Freehold  
Council Tax Band: E  
Estate Charge: Approx. £220.00 P/A

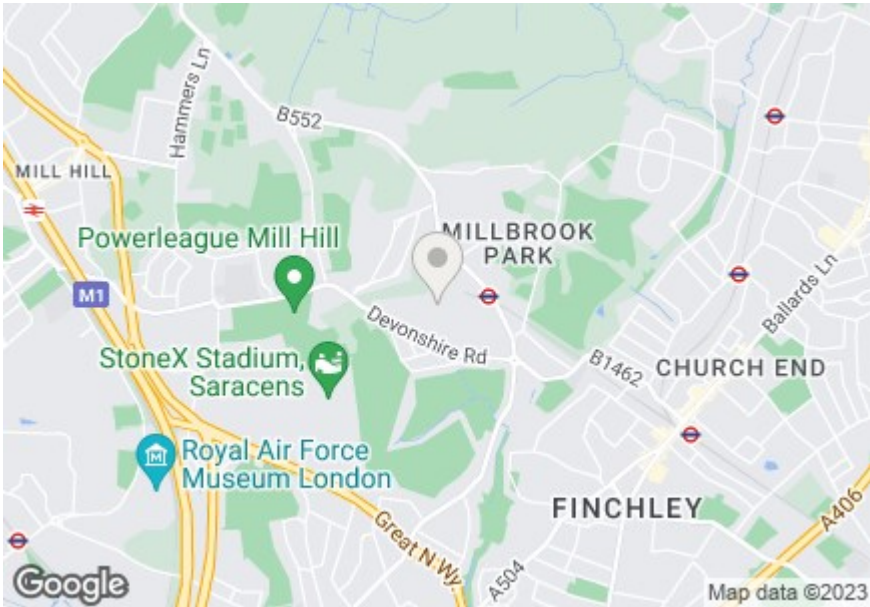

Nearest Stations

Mill Hill East Station	0.2 miles
Finchley Central Station	1.1 miles
West Finchley Station	1.1 miles

Property Description

Conveniently located in this popular location off Devonshire Road is this chain-free, modern two double bedroom house nestled on a tranquil street. This immaculate home offers the perfect blend of comfort, convenience, and contemporary living. As you step inside, you'll be greeted by a spacious 15ft reception room, providing an inviting space to relax and entertain. The adjacent modern kitchen is a chef's delight, boasting sleek finishes and ample counter space. A convenient downstairs cloakroom adds to the practicality of this well-designed property.

Outside, a private rear garden awaits, perfect for al fresco dining or a morning coffee. Additionally, this property comes with the valuable perk of two allocated parking spaces. Situated in the sought-after Mill Hill neighborhood, you'll have easy access to Mill Hill East Station, Waitrose, and Virgin Active gym, all just a short stroll away. Don't miss the opportunity to make this fantastic property your new home. To really appreciate the size, style and condition an internal viewing is highly recommended via vendor main agents Adam Hayes Estate Agents.

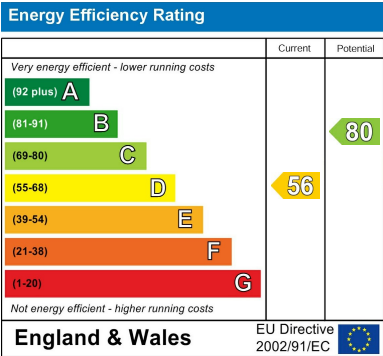

Adam Hayes - Finchley Central Office - Sales 348 Regents Park Road, Finchley Central, London, N3 2LJ

Tel: 0208 189 6333 Email: info@adam-hayes.co.uk Web: www.adam-hayes.co.uk

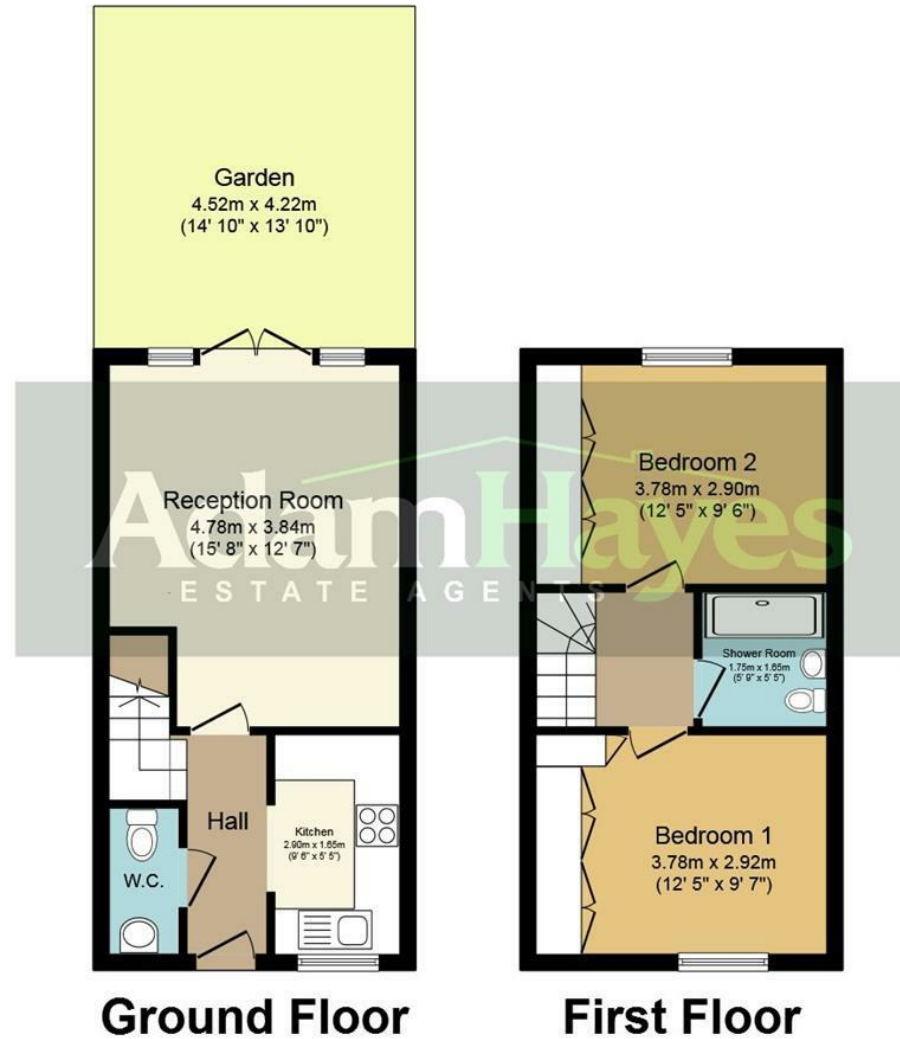

Total floor area 59.6 sq.m. (642 sq.ft.) approx

This plan is for illustration purposes only and may not be representative of the property. Plan not to scale.

These particulars, whilst believed to be accurate, are set out as a general outline only for guidance and do not constitute any part of an offer or contract. Intending purchasers or prospective tenants should not rely on them as statements or representation of fact, but must satisfy themselves by inspection or otherwise as to their accuracy. We have not carried out a detailed survey, not tested the services, appliances and specific fittings. Room sizes should not be relied upon for carpets and furnishings. The measurements given are approximate. No person in this firm's employment has the authority to make or give any representation or warranty in respect of the property.